

# Stainless steel air intake/exhaust port with wire mesh

## USAB



### Description

USAB air intake/exhaust ports are used to terminate ductwork ends in mechanical, gravity or heat-recovery ventilation systems. Unlike louvre blades, the wire mesh generates very low air flow resistance while protecting against the ingress of dry leaves, debris or birds into the ductwork. The product is made from stainless steel, and the gasket underneath is made from EPDM rubber and provides a tight and snug fit to the wall. The inward part of the port fits spiral coiled ducts and flexible ducts.

#### Available materials — Product code examples

USAB -....- stainless steel

#### Product code example

Product code: **USAB - aaa**

type \_\_\_\_\_  
 Ød \_\_\_\_\_

### Dimensions

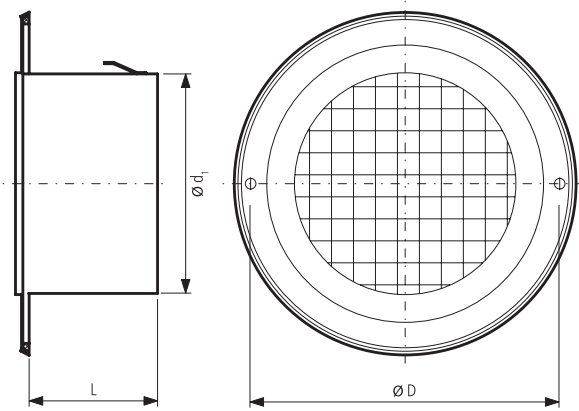

Product code	Ød <sub>1</sub> (mm)	ØD (mm)	L (mm)	Air flow rate (cm <sup>2</sup> )
USAB-100	100	133	52	65
USAB-125	125	165	52	101
USAB-150	150	192	62	147
USAB-160	160	192	62	157
USAB-200	200	265	62	235