

HVAC roof feet

ST-ROF-AWL



Description

The ST-ROF-AWL roof feet are heavy-duty supports for installation of large HVAC units on the roof. The roof foot is designed so as to ensure distribution of the HVAC unit's weight over a relatively large area of the roof, thus removing the risk of breaking the roof and the ceiling structure. The rubber-based material helps to eliminate vibrations generated by the HVAC unit. The HVAC unit is fastened to the roof foot with an LDBST channel strut.

Foot length: 250 / 450 / 600 / 1000 mm

Material: SBR (water-resistant)

Max. load: 250 mm ≤ 1070 N, 450 mm ≤ 2060 N,
600 mm ≤ 3040 N, 1000 mm ≤ 5000 N

Fire rating class B2 acc to DIN 4102

Temperature resistance: -40°C to +80°C

Product code examples

Product code: **ST-ROF-AWL - aaa**

type _____
L _____

Dimensions

ST-ROF-AWL-250, ST-ROF-AWL-450

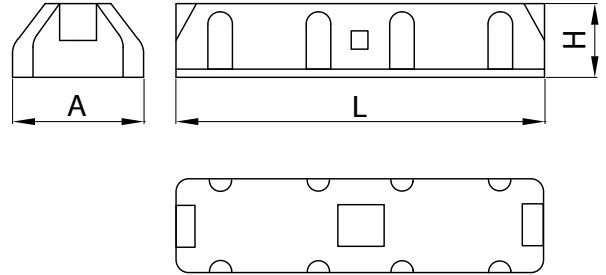

ST-ROF-AWL-600, ST-ROF-AWL-1000

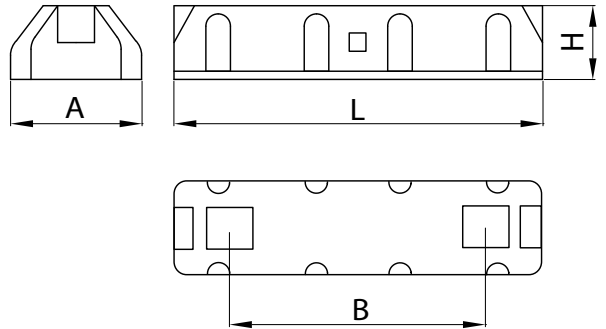

Code	A [mm]	B [mm]	L [mm]	H [mm]	Weight [kg]
ST-ROF-AWL-250	160	-	250	90	0,48
ST-ROF-AWL-450	160	-	450	90	1,75
ST-ROF-AWL-600	160	470	600	90	3,10
ST-ROF-AWL-1000	160	755	1000	90	10,2