

Butt-welded pipe for dust extraction system

SRGWQT

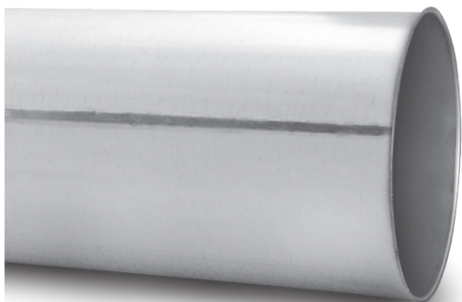

Description

Butt-welded pipe for transporting air and dust. TRANS-Quick system is made of galvanised steel sheet, 0.7 and 0.9 mm in thickness. Depending on the wall thickness there are available various lengths:

0.7 mm thickness: L=500 / 1000 mm

0.9 mm thickness: L=500 / 1000 mm

Available materials - designation example

SRGWQT-200-07-0100 - galvanised steel sheet

Designation example

Product Code: **SRGLQT - aaa - bbb - ccc**

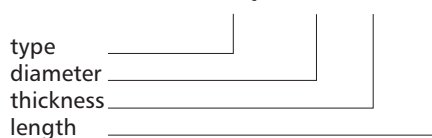

Dimensions

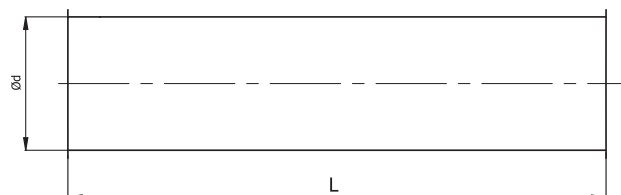

| Product Code | Diameter [mm] | Thickness [mm] | Length L [mm] |
|---------------------|---------------|----------------|---------------|
| SRGWQT-100-070-0050 | 100 | 0.7 | 500 |
| SRGWQT-100-070-0100 | 100 | 0.7 | 1000 |
| SRGWQT-125-070-0050 | 125 | 0.7 | 500 |
| SRGWQT-125-070-0100 | 125 | 0.7 | 1000 |
| SRGWQT-150-070-0050 | 150 | 0.7 | 500 |
| SRGWQT-150-070-0100 | 150 | 0.7 | 1000 |
| SRGWQT-160-070-0050 | 160 | 0.7 | 500 |
| SRGWQT-160-070-0100 | 160 | 0.7 | 1000 |
| SRGWQT-180-070-0050 | 180 | 0.7 | 500 |
| SRGWQT-180-070-0100 | 180 | 0.7 | 1000 |
| SRGWQT-200-070-0050 | 200 | 0.7 | 500 |
| SRGWQT-200-070-0100 | 200 | 0.7 | 1000 |
| SRGWQT-225-070-0050 | 225 | 0.7 | 500 |
| SRGWQT-225-070-0100 | 225 | 0.7 | 1000 |
| SRGWQT-250-070-0050 | 250 | 0.7 | 500 |
| SRGWQT-250-070-0100 | 250 | 0.7 | 1000 |
| SRGWQT-300-070-0050 | 300 | 0.7 | 500 |
| SRGWQT-300-070-0100 | 300 | 0.7 | 1000 |
| SRGWQT-315-070-0050 | 315 | 0.7 | 500 |
| SRGWQT-315-070-0100 | 315 | 0.7 | 1000 |
| SRGWQT-350-070-0050 | 350 | 0.7 | 500 |
| SRGWQT-350-070-0100 | 350 | 0.7 | 1000 |
| SRGWQT-400-070-0050 | 400 | 0.7 | 500 |
| SRGWQT-400-070-0100 | 400 | 0.7 | 1000 |
| SRGWQT-450-070-0050 | 450 | 0.7 | 500 |
| SRGWQT-450-070-0100 | 450 | 0.7 | 1000 |
| SRGWQT-500-070-0050 | 500 | 0.7 | 500 |
| SRGWQT-500-070-0100 | 500 | 0.7 | 1000 |
| SRGWQT-550-070-0050 | 550 | 0.7 | 500 |
| SRGWQT-550-070-0100 | 550 | 0.7 | 1000 |
| SRGWQT-600-070-0050 | 600 | 0.7 | 500 |
| SRGWQT-600-070-0100 | 600 | 0.7 | 1000 |

Butt-welded pipe for dust extraction system

SRGWQT

| <i>Product Code</i> | <i>Diameter [mm]</i> | <i>Thickness [mm]</i> | <i>Length L [mm]</i> |
|---------------------|--------------------------|---------------------------|--------------------------|
| SRGWQT-200-090-0050 | 200 | 0.9 | 500 |
| SRGWQT-200-090-0100 | 200 | 0.9 | 1000 |
| SRGWQT-225-090-0050 | 225 | 0.9 | 500 |
| SRGWQT-225-090-0100 | 225 | 0.9 | 1000 |
| SRGWQT-250-090-0050 | 250 | 0.9 | 500 |
| SRGWQT-250-090-0100 | 250 | 0.9 | 1000 |
| SRGWQT-300-090-0050 | 300 | 0.9 | 500 |
| SRGWQT-300-090-0100 | 300 | 0.9 | 1000 |
| SRGWQT-315-090-0050 | 315 | 0.9 | 500 |
| SRGWQT-315-090-0100 | 315 | 0.9 | 1000 |
| SRGWQT-350-090-0050 | 350 | 0.9 | 500 |
| SRGWQT-350-090-0100 | 350 | 0.9 | 1000 |
| SRGWQT-400-090-0050 | 400 | 0.9 | 500 |
| SRGWQT-400-090-0100 | 400 | 0.9 | 1000 |
| SRGWQT-450-090-0050 | 450 | 0.9 | 500 |
| SRGWQT-450-090-0100 | 450 | 0.9 | 1000 |
| SRGWQT-500-090-0050 | 500 | 0.9 | 500 |
| SRGWQT-500-090-0100 | 500 | 0.9 | 1000 |
| SRGWQT-550-090-0050 | 550 | 0.9 | 500 |
| SRGWQT-550-090-0100 | 550 | 0.9 | 1000 |
| SRGWQT-600-090-0050 | 600 | 0.9 | 500 |
| SRGWQT-600-090-0100 | 600 | 0.9 | 1000 |
| SRGWQT-630-090-0050 | 630 | 0.9 | 500 |
| SRGWQT-630-090-0100 | 630 | 0.9 | 1000 |