

# Airtight shut-off dampers

## FLX-DAT



### Description

FLX-DAT dampers are a good choice when the ductwork closure must be airtight. The damper is used for cutting off the airflow. The damper closure angle is between 0 and 90°. The FLX-DAT airtight, shutoff dampers are made from galvanized steel sheet. Available also damper version made from stainless steel on special request.

#### Product code example

Product code: **FLX-DAT - 75**

type \_\_\_\_\_  
 $\varnothing d_1$  \_\_\_\_\_

### Dimensions

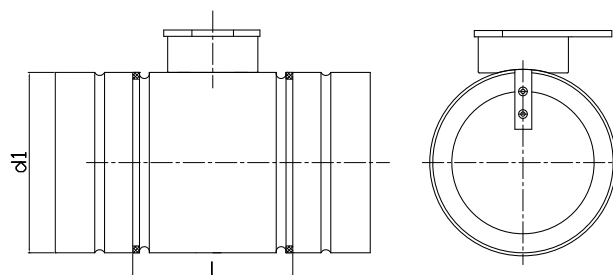

Product code	$d_1$ [mm]	L [mm]
FLX-DAT-75	75	110
FLX-DAT-90	90	110