

Segmented end cap with handle for round ducts

CSH

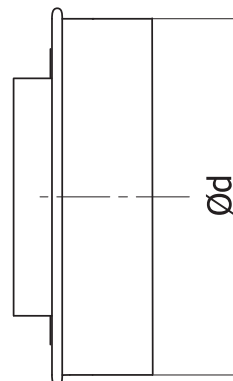

Dimensions



Description

The CSH segmented end caps are designed for blinding the ends of round ventilation ducts which need to be accessed at frequent intervals. To facilitate this, end caps are provided with one or two handles (according to the diameter).

Available materials — Product code examples

- CSH-... - galvanized steel sheet
- CSH-K-... - 1.4301/304 stainless steel sheet
- CSH-K-...-316L - 1.4404/316L stainless steel sheet
- CSH-A-... - aluminium sheet
- CSH-CU-... - copper sheet

Product code example

Product code: CSH - aaa

type _____
 Ød _____

Ød (mm)	Weight (kg)
80*	0.10
100*	0.10
125*	0.10
140	0.10
150	0.20
160	0.20
180	0.30
200	0.30
224	0.30
250	0.60
280	0.60
300	0.70
315	0.90
355	1.20
400	1.20
450	1.80
500	1.70
560	2.20
600	2.60
630	2.80
710	4.50
800	5.40
900	6.60
1000	7.90
1120	10.10
1250	12.20
1400	22.00
1500	25.70
1600	28.80

* pressed