

Segmented end cap without a gasket

CSF

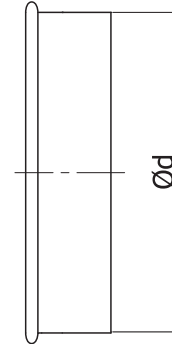

Dimensions



Description

The end cap is made of segments. The end cap is a female piece mounted at the end of a fitting with or without a gasket to blind it. The class of air tightness of a gasket-free joint can be improved by wrapping the end cap joint and the screws or rivets used to fasten it to the duct with the TAL, TALE, or DUCT sealing tape.

Available materials - Product code example

- CSF-... - galvanized steel sheet
- CSF-K-... - 1.4301/304 stainless steel sheet
- CSF-K-...- 316L - 1.4404/316L stainless steel sheet, molybdenum-enriched
- CSF-A-... - AW-1050A H24 aluminium sheet
- CSF-CU-... - M1E z4 copper sheet

Product code example

Product code: CSF - aaa

type _____
 Ød _____

Installation method



$\text{Ø}d_{nom}$ [mm]	Weight [kg]
140	0.10
150	0.20
160	0.20
180	0.30
200	0.30
224	0.30
250	0.60
280	0.60
300	0.70
315	0.90
355	1.20
400	1.20
450	1.80
500	1.70
560	2.20
600	2.60
630	2.80
710	4.50
800	5.40
900	6.60
1000	7.90
1120	10.10
1250	12.20
1400	22.00
1500	25.70
1600	28.80