

Segmented plug end without a gasket

CS



Description

The plug end is made of segments. The end cap has a male end inserted into the duct to blind and seal its end. The class of air tightness can be improved by wrapping the plug end joint and the screws or rivets used to fasten it to the duct with the TAL, TALE, or DUCT sealing tape.

Available materials - Product code example

- CS-... - galvanized steel sheet
- CS-K... - 1.4301/304 stainless steel sheet
- CS-K-...- 316L - 1.4404/316L stainless steel sheet, molybdenum-enriched
- CS-A... - AW-1050A H24 aluminium sheet
- CS-CU... - M1E z4 copper sheet
- CS-ZM... - ZM310 coating (only up to a diameter of $\varnothing d1 = 500\text{mm}$)

Product code example

Product code: **CS - aaa**

type _____
 $\varnothing d$ _____

Installation method

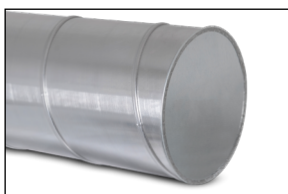

Dimensions

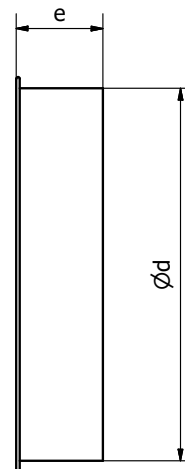

$\varnothing d_{nom}$ [mm]	Weight [kg]
140	0.10
150	0.20
160	0.20
180	0.30
200	0.30
224	0.30
250	0.60
280	0.60
300	0.70
315	0.90
355	1.20
400	1.20
450	1.70
500	1.80
560	2.20
600	2.60
630	2.80
710	4.50
800	5.40
900	6.60
1000	7.90
1120	10.10
1250	12.20
1400	22.00
1500	25.70
1600	28.80